

NEW Lossnay Unit

LGH-150/200/250RVXT-E

Available March 2016

Features

- » Single-deck slim design
- » Large air volume (417-694 L/s)
- » Air volume control by CO₂ sensor
- » Adjustable fan speed (25%, 50%, 75%, 100%)
- » Sensible and latent heat recovery
- » Energy savings technology
- » Auto ventilation, by pass mode, night purge mode
- » Easy maintenance

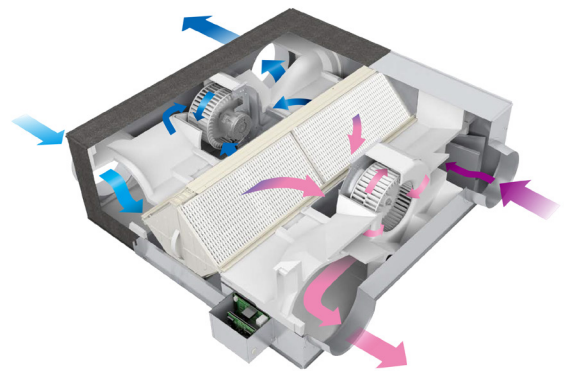

Specifications

Model	LGH-150RVXT-E								LGH-200RVXT-E								LGH-250RVXT-E							
Electrical power supply	220-240V50Hz, 220V/60Hz																							
Ventilation mode	Heat recovery Mode				Bypass mode				Heat recovery Mode				Bypass mode				Heat recovery Mode				Bypass mode			
Fan speed	SP4	SP3	SP2	SP1	SP4	SP3	SP2	SP1	SP4	SP3	SP2	SP1	SP4	SP3	SP2	SP1	SP4	SP3	SP2	SP1	SP4	SP3	SP2	SP1
Running current (A)	4.30	2.40	1.10	0.36	3.40	1.80	0.77	0.31	5.40	2.70	1.10	0.39	5.00	2.20	0.85	0.34	7.60	3.60	1.40	0.57	6.90	3.10	1.30	0.49
Input power	792	421	176	48	625	334	134	37	1000	494	197	56	916	407	150	45	1446	687	244	82	1298	587	212	69
Temperature exchange efficiency (%)	80.0	80.5	81.0	81.5	-	-	-	-	80.0	81.0	82.5	84.0	-	-	-	-	77.0	79.0	80.5	82.5	-	-	-	-
Air volume	(m ³ /h)																							
	(L/s)																							
External static pressure (Pa)	Supply																							
	Return																							
Temperature exchange efficiency %	80.0	80.5		81.5					80.0	81.0	82.5	84.0					77.0	79.0	80.5	82.5	-	-	-	-
Enthalpy exchange efficiency (%)	Heating																							
	Cooling																							
Noise (dB)	39.5	35.5	29.5	22.0	39.0	33.0	26.5	20.5	39.5	35.5	28.0	22.0	40.5	34.5	27.0	20.5	43.0	39.0	32.0	24.0	44.0	38.5	31.0	22.5
Dimensions (HxWxD)mm	500x1450x1980																							
Weight (kg)	156								159								198							